



VERTICAL STATIONARY DD

VFD - VARIABLE SPEEDS, PROGRAMMABLE

Cattle Feeding Equipment & Solutions

[Return to Website Click Here](#)



VS-800DD VERTICAL STATIONARY - VFD

(TWIN AUGER)

VS-800DD DIAGRAM

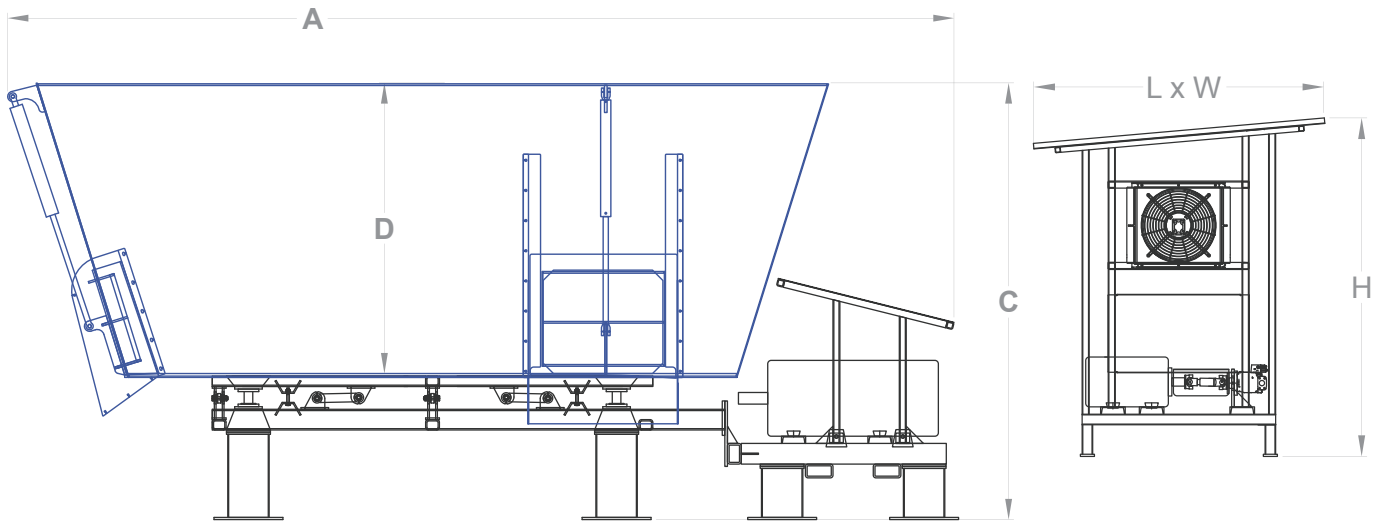

UNIT SPECIFICATIONS	
NUMBER OF AUGERS	2
VOLUME (CU.FT.)	869
MAX LOAD @ 25LBS/CU.FT.	21725
A OVERALL LENGTH	275.00"
B OVERALL WIDTH SIDE DOORS	133.00"
OVERALL WIDTH END DOOR	114.00"
C OVERALL HEIGHT	127.00"
D CHAMBER DEPTH	84.00"
E DOOR CHUTE CLEARANCE	28.00"
MINI ELECTRIC MOTOR HORSE POWER	125
POWER SKID LENGTH	113.00"
POWER SKID WIDTH	76.00"
POWER SKID HEIGHT	88.50

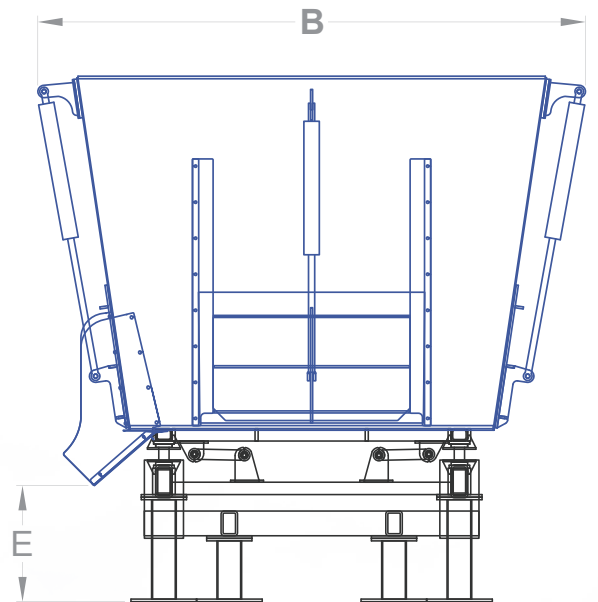

* ALL HEIGHTS BASED ON 75R22.5 TIRES

Performance, Longevity | Made in the U.S.A 

& Quality Service

Call Today 209-722-4146

[Return to Website Click Here](#)



VS-800DD VERTICAL STATIONARY - VFD

(TWIN AUGER)

VS-800DD

STANDARD EQUIPMENT

1. 800 Cu.Ft. Mixing Chamber | 7 Ft. Side Wall
2. 1" Steel Sub-Floor & 6mm | 0.236 in Stainless Steel Baffles
3. Vertical Auger with 5mm Stainless Steel On Bottom Flight, 3mm Stainless Steel Auger Cap, & Stainless Round Bar Around Perimeter
4. Two Heavy Duty Planetary Gear Boxes (RR-5200)
Integrated With 90 Degree Bevel Gear
5. Large Rear Door Discharges to (Dedicated Dogleg Conveyor)
(1 Mixer Setup) Stationary Standard
6. 200 HP VFD Control Panel (Indoor Installation)
460V, 3 Phase, 375 Amp With Harmonic Filter & 3% Line Reactor
7. Includes NEMA 1 Panel Enclosure, Door Mounted Keypad
With Start/Stop Push Buttons
8. Hydraulic Power Pack: Open/Closes Discharge Door(s),
Drives Circulator Pump & Hydraulic Cooler for A75 Radiator
9. 150 HP Electric Motor (1800 RPM)
Includes High Speed PTO Shaft, Complete With Drive Flange
10. Includes 12V Inverter for Scales & Solenoid Valves
11. Mounted On A Sub Frame Skid -
Includes Discharge Door & Slide Chute, Plus Ladder for Viewing
12. 4 X 30,000 Lbs. Capacity CT Cells- 3.5" Diameter
13. 5 Premium Busatis Vertical Blades (Per Auger) + 2 Counter Knives
14. Painted Laird White With Blue Trim

Return to Website Click Here



VS-1200DD VERTICAL STATIONARY - VFD

(TWIN AUGER)

VS-1200DD DIAGRAM

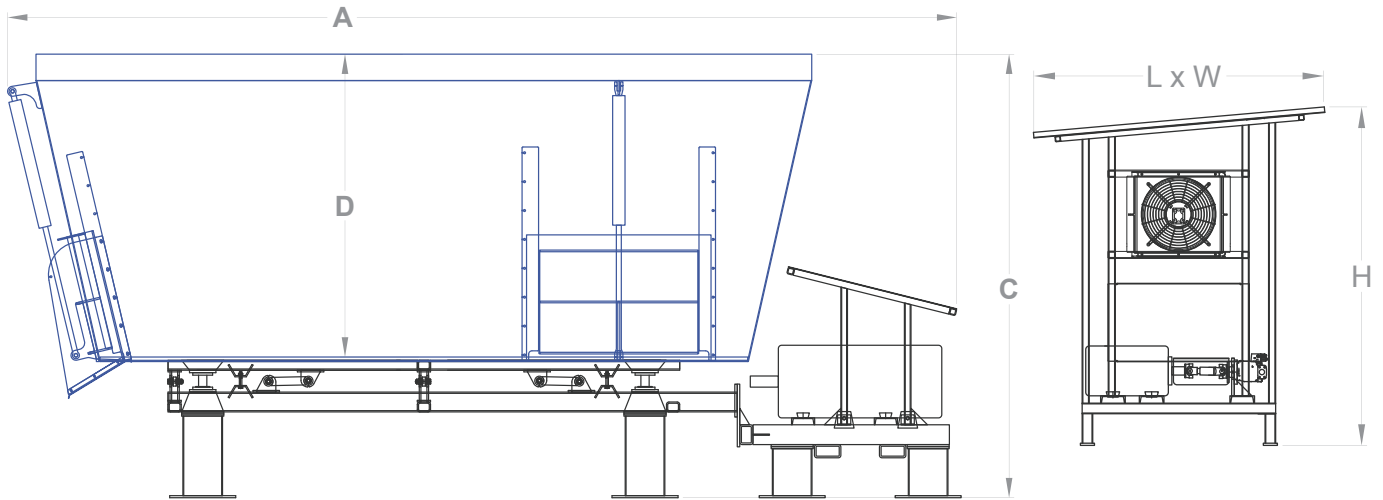

UNIT SPECIFICATIONS	
NUMBER OF AUGERS	2
VOLUME (CU.FT.)	1079
MAX LOAD @ 25LBS/CU.FT.	27100
A OVERALL LENGTH	288.00"
B OVERALL WIDTH SIDE DOORS	137.25"
OVERALL WIDTH END DOOR	118.00"
C OVERALL HEIGHT	135.00"
D CHAMBER DEPTH	92.00"
E DOOR CHUTE CLEARANCE	28.00"
MINI ELECTRIC MOTOR HORSE POWER	200
POWER SKID LENGTH	113.00"
POWER SKID WIDTH	76.00"
POWER SKID HEIGHT	88.50

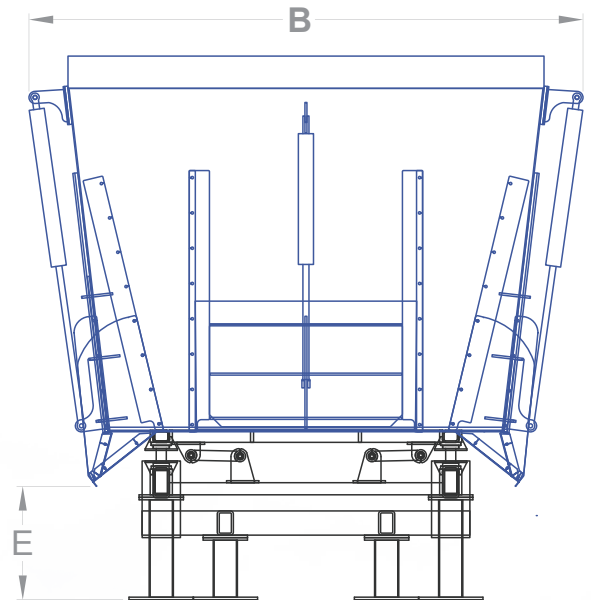

* ALL HEIGHTS BASED ON 75R22.5 TIRES

Performance, Longevity | Made in the U.S.A. 
& Quality Service

Call Today 209-722-4146

[Return to Website Click Here](#)



VS-1200DD VERTICAL STATIONARY - VFD

(TWIN AUGER)

VS-1200DD

STANDARD EQUIPMENT

1. 1200 Cu.Ft. Mixing Chamber | 7 Ft. Side Wall Plus 8" Belt Extension
2. 1" Steel Sub-Floor & 6mm | 0.236 in Stainless Steel Baffles
3. Vertical Auger with 5mm Stainless Steel On Bottom Flight, 3mm Stainless Steel Auger Cap, & Stainless Round Bar Around Perimeter
4. Two Heavy Duty Planetary Gear Boxes (RR-5200)
Integrated With 90 Degree Bevel Gear
5. Large Rear Door Discharges to (Dedicated Dogleg Conveyor)
(1 Mixer Setup) Stationary Standard
6. 200 HP VFD Control Panel (Indoor Installation)
460V, 3 Phase, 375 Amp With Harmonic Filter & 3% Line Reactor
7. Includes NEMA 1 Panel Enclosure, Door Mounted Keypad With
Start/Stop Push Buttons
8. Hydraulic Power Pack: Open/Closes Discharge Door(s),
Drives Circulator Pump & Hydraulic Cooler for A75 Radiator
9. 200 HP Electric Motor (1800 RPM) Includes High Speed PTO Shaft,
Complete With Drive Flange
10. Includes 12V Inverter for Scales & Solenoid Valves
11. Mounted On A Sub Frame Skid -
Includes Discharge Door & Slide Chute, Plus Ladder for Viewing
12. 4 X 30,000 Lbs. Capacity CT Cells- 3.5" Diameter
13. 5 Premium Busatis Vertical Blades (Per Auger) + 2 Counter Knives
14. Painted Laird White With Blue Trim

Return to Website Click Here



VS-1400DD VERTICAL STATIONARY - VFD

(TWIN AUGER)

VS-1400DD DIAGRAM

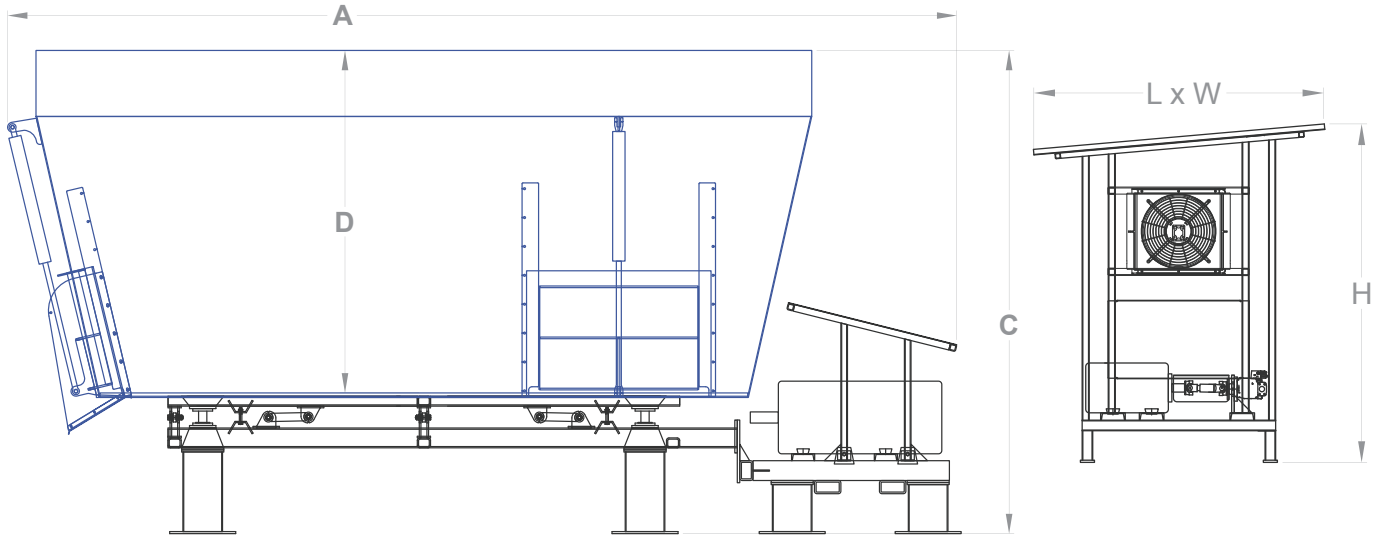

UNIT SPECIFICATIONS	
NUMBER OF AUGERS	2
VOLUME (CU.FT.)	1249
MAX LOAD @ 25LBS/CU.FT.	31225
A OVERALL LENGTH	288.00"
B OVERALL WIDTH SIDE DOORS	137.25"
OVERALL WIDTH END DOOR	118.00"
C OVERALL HEIGHT	147.00"
D CHAMBER DEPTH	104.00"
E DOOR CHUTE CLEARANCE	28.00"
MINI ELECTRIC MOTOR HORSE POWER	200
POWER SKID LENGTH	113.00"
POWER SKID WIDTH	76.00"
POWER SKID HEIGHT	88.50

* ALL HEIGHTS BASED ON 75R22.5 TIRES

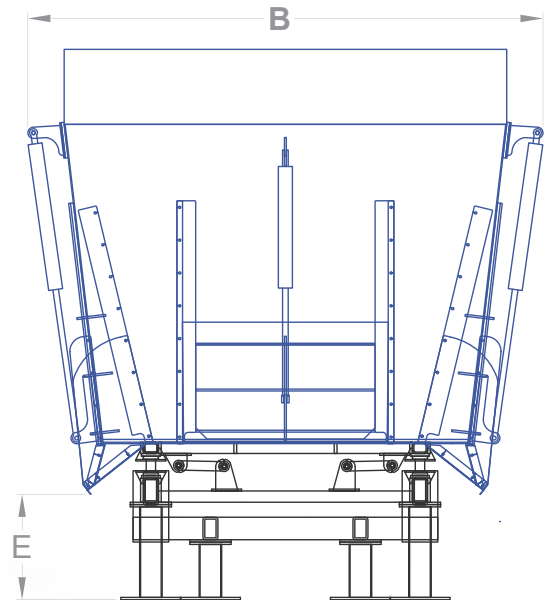

Performance, Longevity | Made in the U.S.A 
& Quality Service

Call Today 209-722-4146

[Return to Website Click Here](#)



VS-1400DD VERTICAL STATIONARY - VFD

(TWIN AUGER)

VS-1400DD

STANDARD EQUIPMENT

1. 1400 Cu.Ft. Mixing Chamber | 7 Ft. Side Wall
Plus 20" Steel Extension
2. 1" Steel Sub-Floor & 6mm | 0.236 in Stainless Steel Baffles
3. Vertical Auger with 5mm Stainless Steel On Bottom Flight, 3mm
Stainless Steel Auger Cap, & Stainless Round Bar Around Perimeter
4. Two Heavy Duty Planetary Gear Boxes (RR-5200)
Integrated With 90 Degree Bevel Gear
5. Large Door In Rear Discharges to (Dedicated Dogleg Conveyor)
(1 Mixer Setup) Stationary Standard
6. 300 HP VFD Control Panel (Indoor Installation)
460V, 3 Phase, 375 Amp With Harmonic Filter & 3% Line Reactor
7. Includes NEMA 1 Panel Enclosure, Door Mounted Keypad
With Start/Stop Push Buttons
8. Hydraulic Power Pack: Open/Closes Discharge Door(s),
Drives Circulator Pump & Hydraulic Cooler for A75 Radiator
9. 250 HP Electric Motor (1800 RPM) Includes High Speed PTO Shaft,
Complete With Drive Flange
10. Includes 12V Inverter for Scales & Solenoid Valves
11. Mounted On A Sub Frame Skid -
Includes Discharge Door & Slide Chute, Plus Ladder for Viewing
12. 4 X 30,000 Lbs. Capacity CT Cells- 3.5" Diameter
13. 5 Premium Busatis Vertical Blades (Per Auger) + 2 Counter Knives
14. Painted Laird White With Blue Trim

Return to Website Click Here



VS-1500DD XL VERTICAL STATIONARY - VFD

(TWIN AUGER)

VS-1500DD XL DIAGRAM

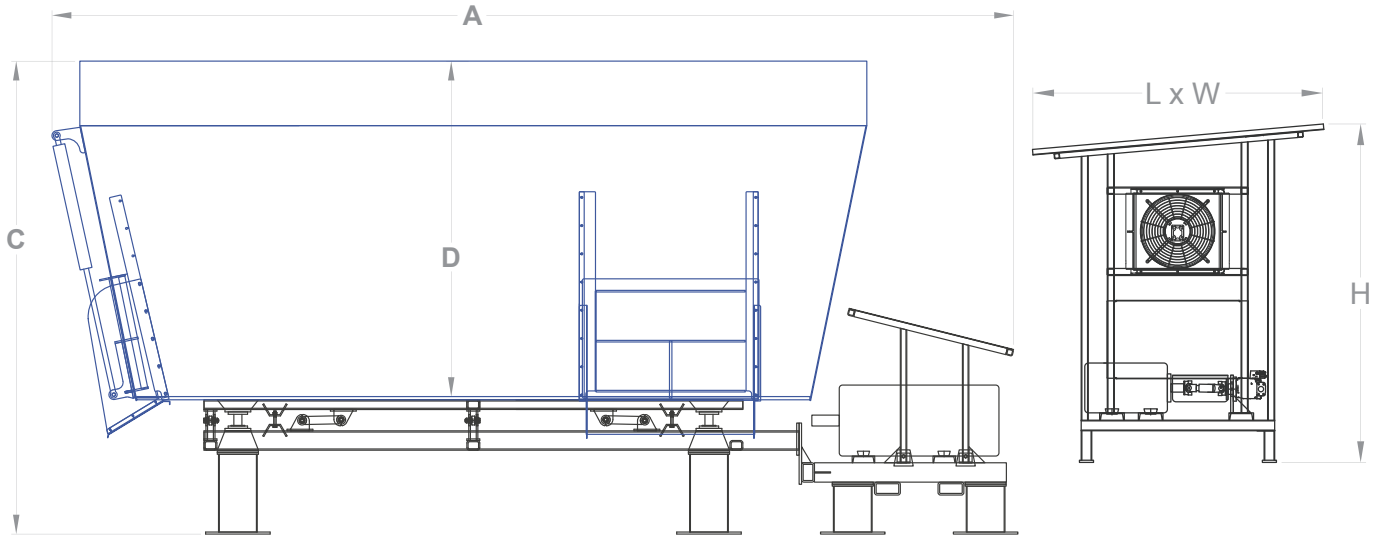

UNIT SPECIFICATIONS	
NUMBER OF AUGERS	2
VOLUME (CU.FT.)	1406
MAX LOAD @ 25LBS/CU.FT.	35150
A OVERALL LENGTH	298.00"
B OVERALL WIDTH SIDE DOORS	147.00"
OVERALL WIDTH END DOOR	128.00"
C OVERALL HEIGHT	145.00"
D CHAMBER DEPTH	104.00"
E DOOR CHUTE CLEARANCE	27.50"
MINI ELECTRIC MOTOR HORSE POWER	300
POWER SKID LENGTH	82.00"
POWER SKID WIDTH	70.00"
POWER SKID HEIGHT	96.00

* ALL HEIGHTS BASED ON 75R22.5 TIRES

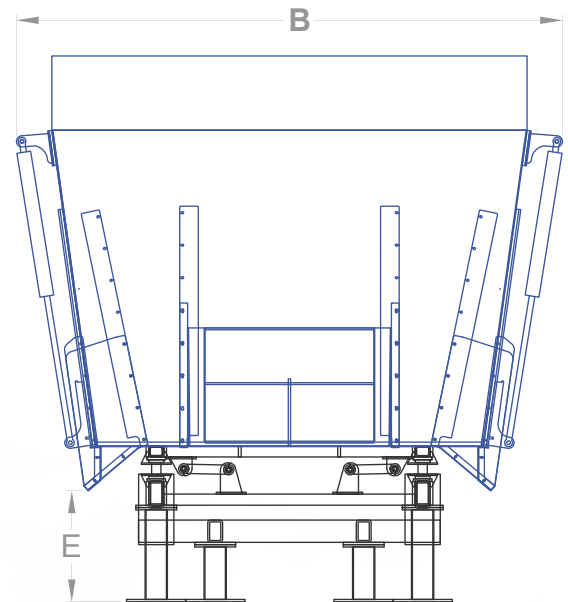

Performance, Longevity | Made in the U.S.A. 
& Quality Service

Call Today 209-722-4146

[Return to Website Click Here](#)



VS-1500DD XL VERTICAL STATIONARY - VFD

(TWIN AUGER)

VS-1500DD XL STANDARD EQUIPMENT

1. 1500 Cu.Ft. Mixing Chamber | 7 Ft. Side Wall
Plus 20" Steel Extension
2. 1" Steel Sub-Floor & 6mm | 0.236 in Stainless Steel Baffles
3. Vertical Auger with 5mm Stainless Steel On Bottom Flight, 3mm
Stainless Steel Auger Cap, & Stainless Round Bar Around Perimeter
4. Two Heavy Duty Planetary Gear Boxes (RR-5200)
Integrated With 90 Degree Bevel Gear
5. Large Rear Door Discharges to (Dedicated Dogleg Conveyor)
(1 Mixer Setup) Stationary Standard
6. 350 HP VFD Control Panel (Indoor Installation)
460V, 3 Phase, 375 Amp With Harmonic Filter & 3% Line Reactor
7. Includes NEMA 1 Panel Enclosure, Door Mounted Keypad
With Start/Stop Push Buttons
8. Hydraulic Power Pack: Open/Closes Discharge Door(s),
Drives Circulator Pump & Hydraulic Cooler for A75 Radiator
9. 300 HP Electric Motor (1800 RPM) Includes High Speed PTO Shaft,
Complete With Drive Flange
10. Includes 12V Inverter for Scales & Solenoid Valves
11. Mounted On A Sub Frame Skid -
Includes Discharge Door & Slide Chute, Plus Ladder for Viewing
12. 4 X 30,000 Lbs. Capacity CT Cells- 3.5" Diameter
13. 5 Premium Busatis Vertical Blades (Per Auger) + 2 Counter Knives
14. Painted Laird White With Blue Trim

Return to Website Click Here



VS-1600DD VERTICAL STATIONARY - VFD

(TRIPLE AUGER)

VS-1600DD DIAGRAM

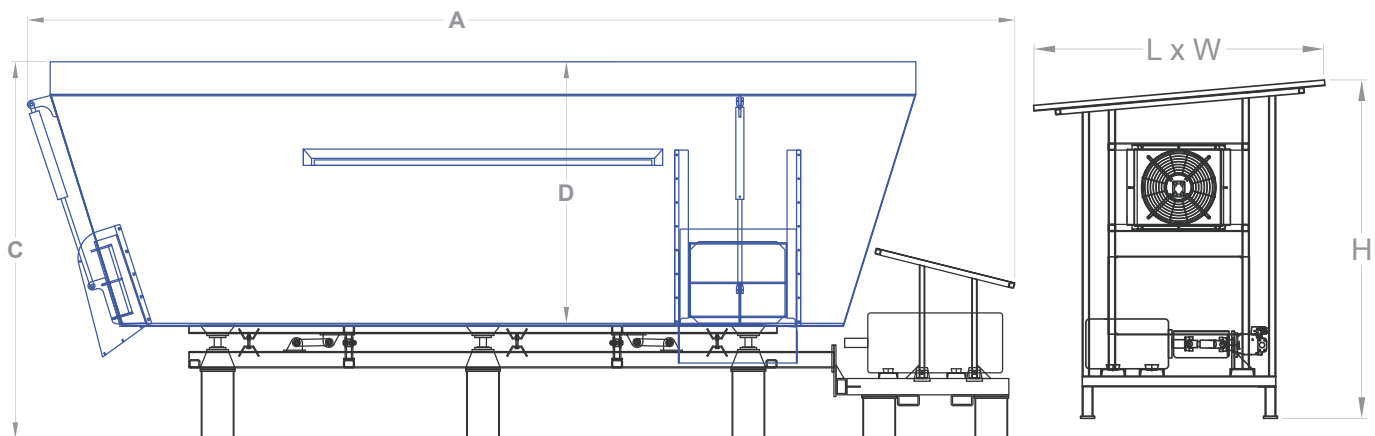

UNIT SPECIFICATIONS	
NUMBER OF AUGERS	3
VOLUME (CU.FT.)	1516
MAX LOAD @ 25LBS/CU.FT.	37900
A OVERALL LENGTH	363.00"
B OVERALL WIDTH SIDE DOORS	133.00"
OVERALL WIDTH END DOOR	114.00"
C OVERALL HEIGHT	139.00"
D CHAMBER DEPTH	96.00"
E DOOR CHUTE CLEARANCE	28.00"
MINI ELECTRIC MOTOR HORSE POWER	300
L POWER SKID LENGTH	82.00"
W POWER SKID WIDTH	70.00"
H POWER SKID HEIGHT	96.00

* ALL HEIGHTS BASED ON 75R22.5 TIRES

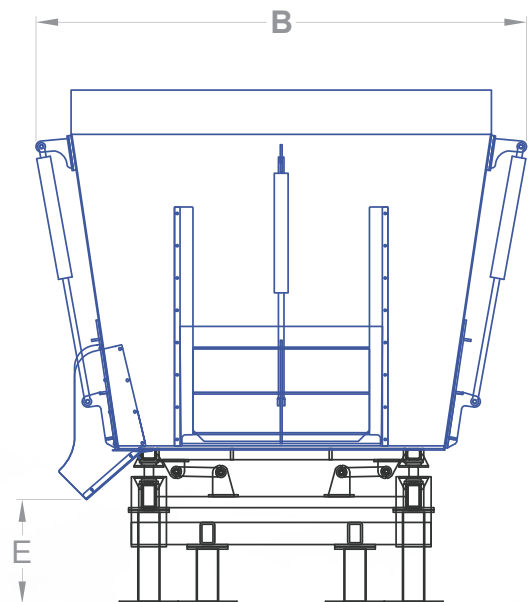

Performance, Longevity | Made in the U.S.A. 
& Quality Service

Call Today 209-722-4146

[Return to Website Click Here](#)



VS-1600DD VERTICAL STATIONARY - VFD

(TRIPLE AUGER)

VS-1600DD

STANDARD EQUIPMENT

1. 1600 Cu.Ft. Mixing Chamber | 7 Ft. Side Wall
Plus 12" Steel Extension
2. 1" Steel Sub-Floor & 6mm | 0.236 in Stainless Steel Baffles
3. Vertical Auger with 5mm Stainless Steel On Bottom Flight, 3mm
Stainless Steel Auger Cap, & Stainless Round Bar Around Perimeter
4. Three Heavy Duty Planetary Gear Boxes (RR5200)
Complete With 90 Degree Bevel Gear
5. Large Rear Door Discharges to (Dedicated Dogleg Conveyor)
(1 Mixer Setup) Stationary Standard
6. 300 HP VFD Control Panel (Indoor Installation)
460V, 3 Phase, 375 Amp With Harmonic Filter & 3% Line Reactor
7. Includes NEMA 1 Panel Enclosure, Door Mounted Keypad
With Start/Stop Push Buttons
8. Hydraulic Power Pack: Open/Closes Discharge Door(s),
Drives Circulator Pump & Hydraulic Cooler for A75 Radiator
9. 300 HP Electric Motor (1800 RPM) Includes High Speed PTO Shaft,
Complete With Drive Flange
10. Includes 12V Inverter for Scales & Solenoid Valves
11. Mounted On A Sub Frame Skid - Includes Discharge Door & Slide Chute
12. 6 X 30,000 Lbs. Capacity CT Cells- 3.5" Diameter
13. 5 Premium Busatis Vertical Blades (Per Auger) & 2 Counter Knives -
Includes Two Extra Kickers For Front & Rear Augers
14. Painted Laird White With Blue Trim

[**Return to Website Click Here**](#)



VS-1800DD VERTICAL STATIONARY - VFD

(TRIPLE AUGER)

VS-1800DD DIAGRAM

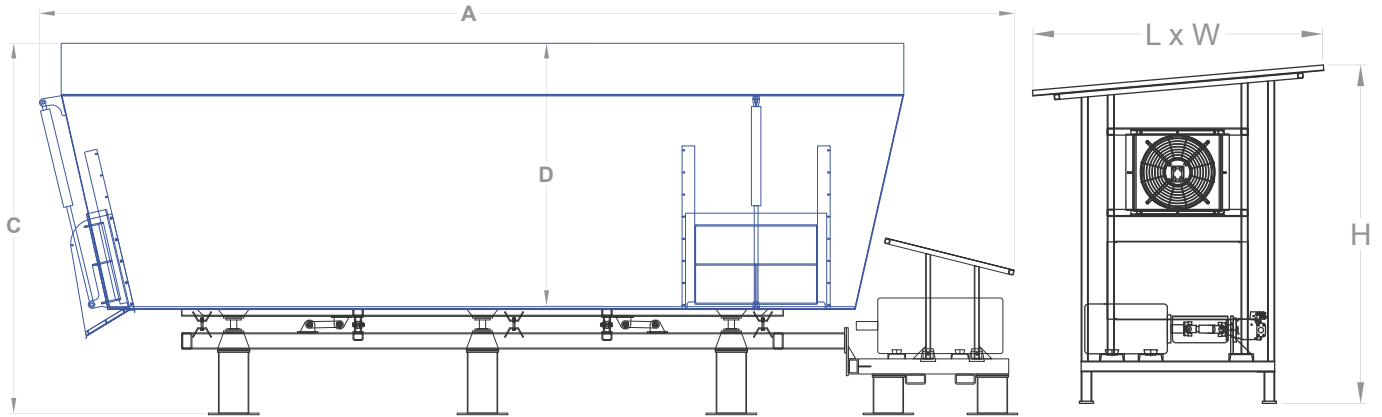

UNIT SPECIFICATIONS	
NUMBER OF AUGERS	3
VOLUME (CU.FT.)	1867
MAX LOAD @ 25LBS/CU.FT.	46675
A OVERALL LENGTH	386.00"
B OVERALL WIDTH SIDE DOORS	137.25"
OVERALL WIDTH END DOOR	118.00"
C OVERALL HEIGHT	146.00"
D CHAMBER DEPTH	104.00"
E DOOR CHUTE CLEARANCE	28.00"
MINI ELECTRIC MOTOR HORSE POWER	300
POWER SKID LENGTH	129.00"
POWER SKID WIDTH	89.00"
POWER SKID HEIGHT	102.00"

* ALL HEIGHTS BASED ON 75R22.5 TIRES

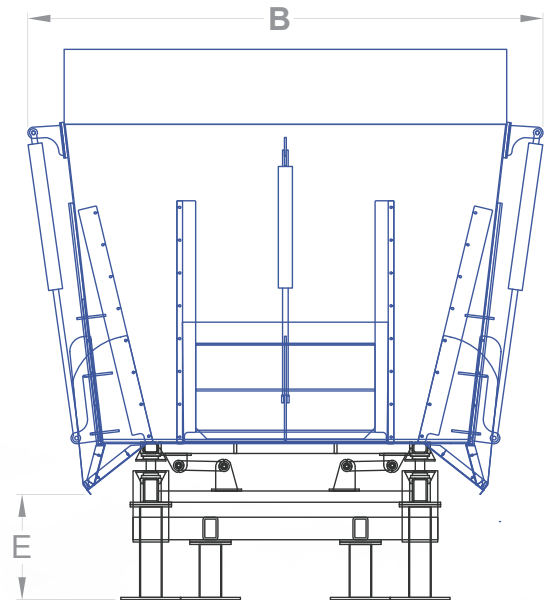

Performance, Longevity | Made in the U.S.A. 
& Quality Service

Call Today 209-722-4146

[Return to Website Click Here](#)



VS-1800DD VERTICAL STATIONARY - VFD

(TRIPLE AUGER)

VS-1800DD

STANDARD EQUIPMENT

1. 1800 Cu.Ft. Mixing Chamber | 7 Ft. Side Wall Plus 20" Steel Extension
2. 1" Steel Sub-Floor & 6mm | 0.236 in Stainless Steel Baffles
3. Vertical Auger with 5mm Stainless Steel On Bottom Flight, 3mm Stainless Steel Auger Cap, & Stainless Round Bar Around Perimeter
4. Three Heavy Duty Planetary Gear Boxes (RR5200)
Complete With 90 Degree Bevel Gear
5. Large Rear Door Discharges to (Dedicated Dogleg Conveyor)
(1 Mixer Setup) Stationary Standard
6. 350 HP VFD Control Panel (Indoor Installation)
460V, 3 Phase, 375 Amp With Harmonic Filter & 3% Line Reactor
7. Includes NEMA 1 Panel Enclosure, Door Mounted Keypad
With Start/Stop Push Buttons
8. Hydraulic Power Pack: Open/Closes Discharge Door(s),
Drives Circulator Pump & Hydraulic Cooler for A75 Radiator
9. 300 HP Electric Motor (1800 RPM) Includes High Speed PTO Shaft,
Complete With Drive Flange
10. Includes 12V Inverter for Scales & Solenoid Valves
11. Mounted On A Sub Frame Skid - Includes Discharge Door & Slide Chute
12. 6 X 30,000 Lbs. Capacity CT Cells- 3.5" Diameter
13. 5 Premium Busatis Vertical Blades (Per Auger) & 2 Counter Knives -
Includes Two Extra Kickers For Front & Rear Augers
14. Painted Laird White With Blue Trim

Return to Website Click Here





Cattle Feeding Equipment & Solutions

531 S. Hwy. 59 | Merced, CA 95341
P: (209) 722-4145 | F: (209) 349-8934 | sales@lairdmfg.com | www.lairdmfg.com

[Return to Website Click Here](http://www.lairdmfg.com)